

Outdoor Learning Environment West Sensory Area

This location has opportunity for stimulation of the senses through water play, sand exploration, interaction with musical instruments, sensing of various surfaces on textured walkways, and participation in art activities at our specially-designed art panel. Students can leave their personal mark here on our handprint walk, and donors can be recognized on the "Walk of Fame" via donor bricks.

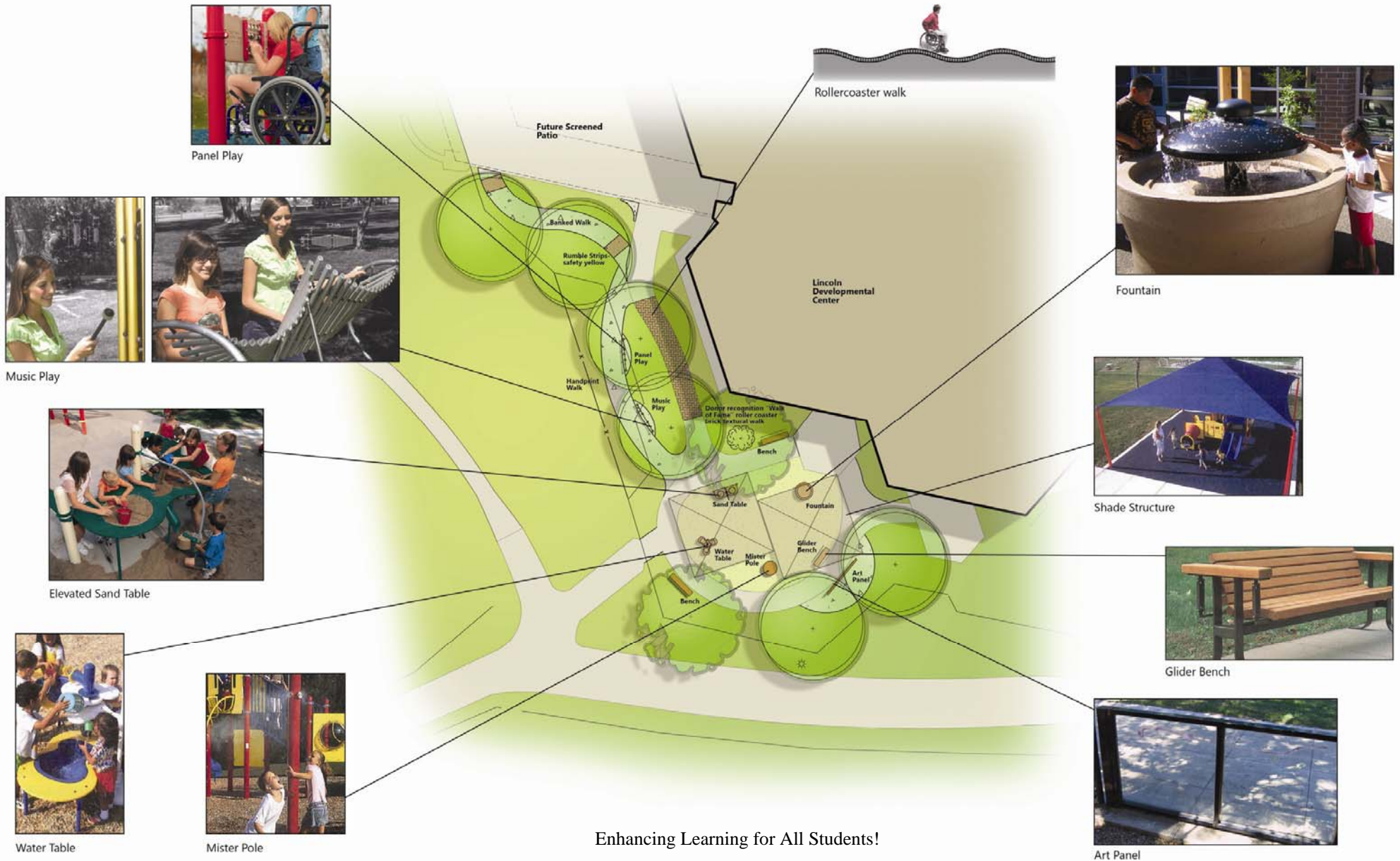

Panel Play



Music Play



Elevated Sand Table



Water Table



Mister Pole



Rollercoaster walk



Fountain



Shade Structure



Glider Bench



Art Panel

Enhancing Learning for All Students!